

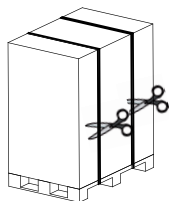

PLASTIC SPACERS ARE INTENDED FOR PACKAGING PURPOSES ONLY.
DO NOT RE-USE WHEN ASSEMBLING MONITOR INTERFACES.

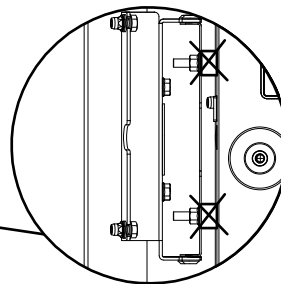

1A)

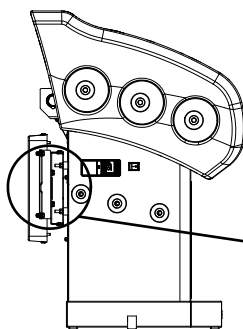

1A)

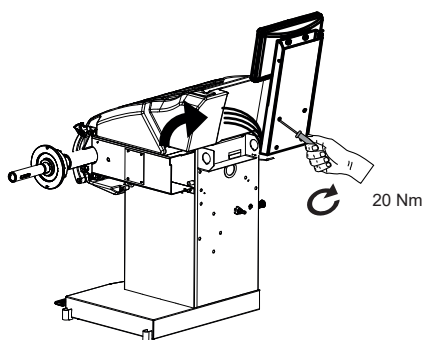

1B)

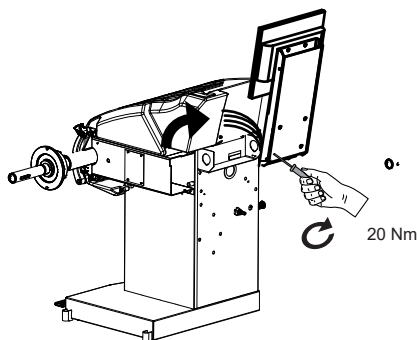

1C)

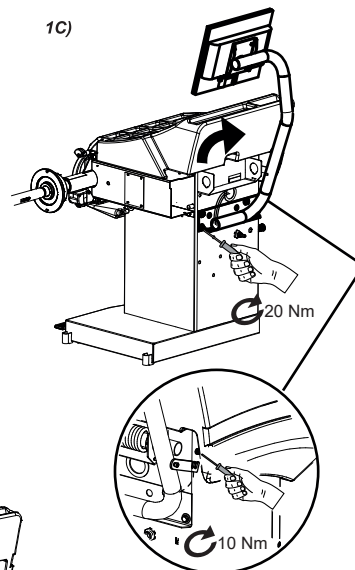

Take care to lock the support bracket of the monitor column

2)

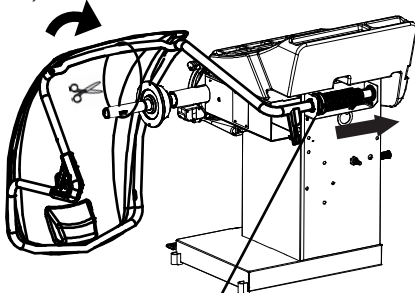

3)

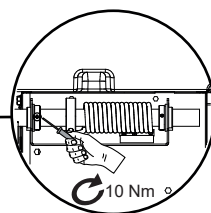
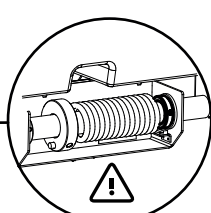
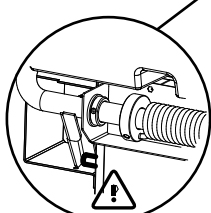
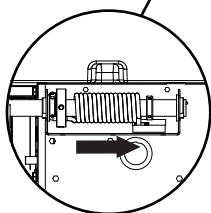
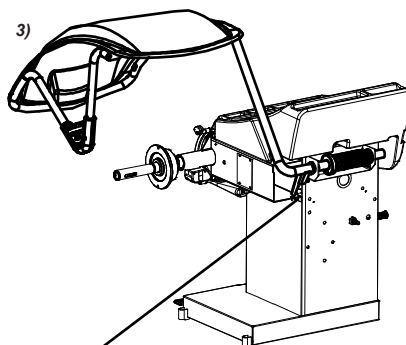

Take care that the pin enters the locking bracket of wheel guard

Take care that the bush goes to lean on base

4)

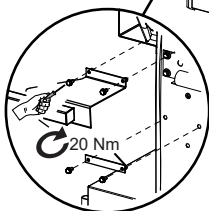
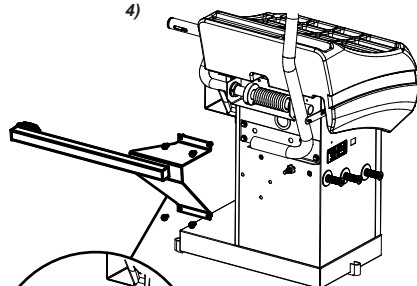

5)

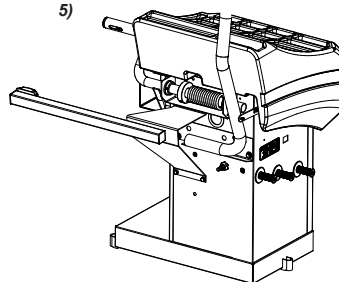

For the electrical connection, follow the instructions on the back

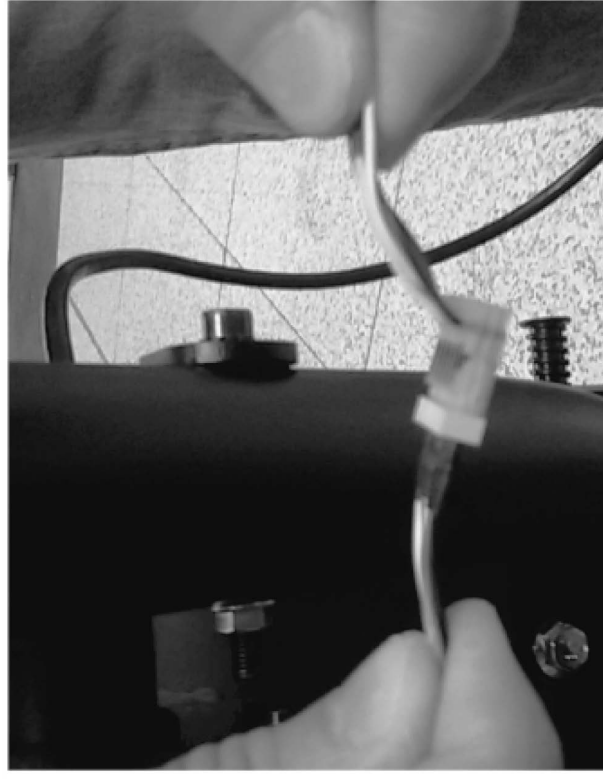

2)



4)

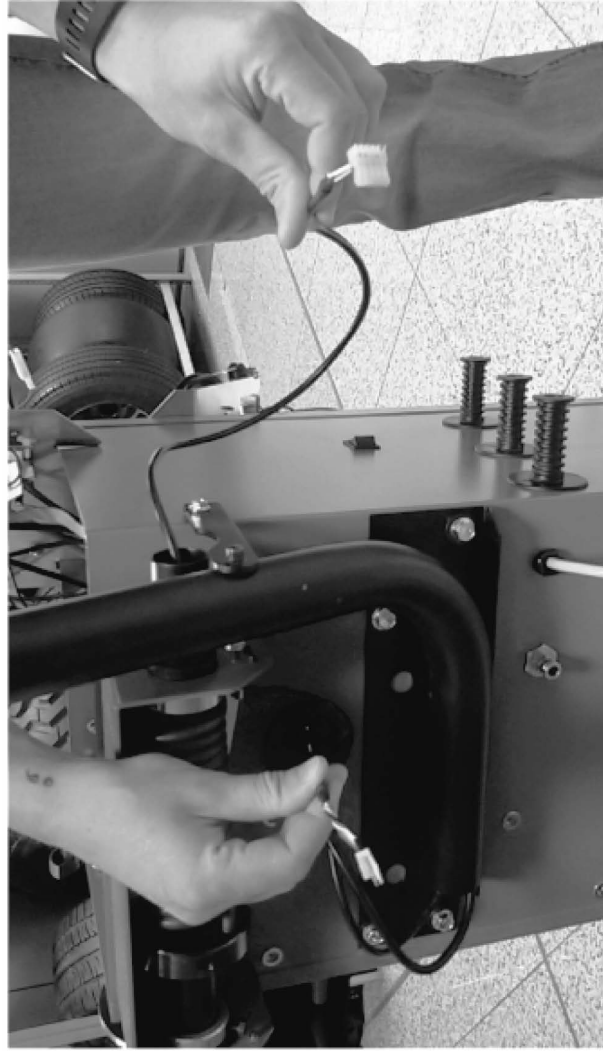

1)



3)